



HITACHI SCROLL Air-conditioning Compressor

- Commercial
Air-Conditioning
Scroll Compressor
- Low sound & low vibration
 - High reliability & efficiency
 - Wide operating range

Air-conditioning R22

Note: Tighten up the flare nut to the following torque.
Flare Ø 12.76: 500kg.cm
Flare Ø 15.08: 800kg.cm
Flare Ø 19.05: 1800kg.cm

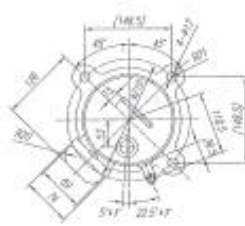

Model	HC109	HC109A	HC109B
Phase 1 or Phase 3	3	3	3
Output Capacity (kW)	3.8	3.75	4.5
Power Source	415V/50Hz		
Displacement (cc/Rev)	11.89	12.02	15.55
Oil Charge (L)	1.5	1.8	1.8
Cooling Capacity (kW)	1.5	1.8	1.8
Amperage	6.5	8	9
EER (kcal/kWh)	2.75	2.8	2.8
Sound Level (dB(A))	63		
Refrigerant	R-22		
Rated Voltage (V)	311-410		
Weight (kg)	25	26	26

Super Green-Power Saving Split AC Remote Control

- Minimum **22** degrees on **Cooling**
- Maximum **26** degrees on **Heating**
- Works on over 2000 different makes and models
- **Super Green Function**
"One Push" easy operation power saver
- Set "on time" 1 to 24 hours

**G.COOL
26°C**

**No more
arguments
on set
points**

**MASSIVE
POWER
SAVINGS**

Ideal for:
Offices
Schools

Mining Dongas
Domestic Homes
Hotels and Motels

**Immediate
Return on
Investment**

**G.HEAT
20°C**



Any-g
SGR-032

DISTRIBUTED BY:

RAS Refrigeration
& Air Supplies
(South Coast)

JALVA PTY LIMITED ACN 052 113 247 ABN 79 806 821 006

Units 8-9, 30 Swan Street, Wollongong NSW 2500

P O Box 6155, Wollongong NSW 2500

Ph: (02)4226 5133 Fax: (02)4226 5383

Email: sales@refrigair.com.au Website: www.refrigair.com.au